

**Couplers**

**Female Thread**

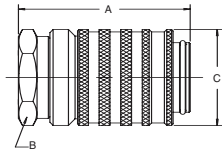

Body Size (in.)	Part No.	Female Thread NPTF	Female Thread ORB	Dimensions (in.)			
				Overall Length	Wrench Flats	Largest Diameter	Wt. (LB.) P/Piece
				A	B	C	
1/8	PD222	1/8-27	–	1.67	0.81	0.96	0.20
1/8	PD240	–	7/16-20	2.12	0.81	0.96	0.26
1/8	PD242	1/4-18	–	2.12	0.81	0.96	0.25
1/8	SSPD242Y**	1/4-18	–	2.12	0.81	0.96	0.25
1/8	PD260	–	9/16-18	2.12	0.81	0.96	0.24

**Male Thread**

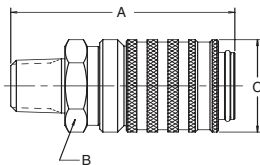

Body Size (in.)	Part No.	Male Thread NPTF	Male Thread ORB	Dimensions (in.)			
				Overall Length	Wrench Flats	Largest Diameter	Wt. (LB.) P/Piece
				A	B	C	
1/8	PD243	1/4-18	–	2.26	0.81	0.96	0.23

**Nipples**

**Female Pipe Thread**

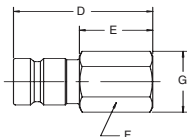

Body Size (in.)	Part No.	Thread Size NPTF	Overall Length	Dimensions (in.)			
				Exposed Length	Hex Size	Largest Diameter	Wt. (LB.) P/Piece
				D	E	F	G
1/8	PD322	1/8-27	1.48	0.78	0.56	0.65	0.06
1/8	PD342	1/4-18	1.63	0.93	0.75	0.87	0.12

**Male Pipe Thread**

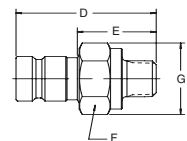

Body Size (in.)	Part No.	Thread Size NPTF	Overall Length	Dimensions (in.)			
				Exposed Length	Hex Size	Largest Diameter	Wt. (LB.) P/Piece
				D	E	F	G
1/8	PD323	1/8-27	1.55	0.85	0.69	0.79	0.17
1/8	BPD323Y*	1/8-27	1.44	0.74	0.63	0.72	0.17
1/8	BPD343Y*	1/4-18	1.48	0.78	0.69	0.79	0.06
1/8	PD343	1/4-18	1.48	0.78	0.69	0.79	0.06
1/8	SSPD343Y**	1/4-18	1.48	0.78	0.69	0.79	0.06
1/8	PD363	3/8-18	1.50	1.13	0.81	0.96	0.09

**Metric Thread**

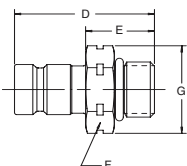

Body Size (in.s)	Part No.	Thread Size Metric	Overall Length	Dimensions (in.)			
				Exposed Length	Hex Size	Largest Diameter	Wt. (LB.) P/Piece
				D	E	F	G
1/8	PD357	M10 x 1.0	1.80	1.10	0.69	0.79	0.17
1/8	PD367C	M14 x 1.5	1.50	0.80	0.75	0.87	0.08
1/8	PD3107	M16 x 1.5	1.54	0.84	0.88	1.01	0.08
1/8	PD3127	M18 x 1.5	1.60	0.90	0.94	1.08	0.09
1/8	PD3147	M20 x 1.5	1.50	0.80	0.75	0.87	0.07

**Male Straight Thread**

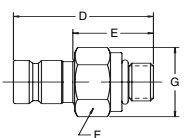

Body Size (in.)	Part* No.	Thread Size ORB	Overall Length	Dimensions (in.)			
				Exposed Length	Hex Size	Largest Diameter	Wt. (LB.) P/Piece
				D	E	F	G
1/8	PD331	3/8-24	1.80	1.10	0.69	0.79	0.17
1/8	PD341	7/16-20	1.60	0.90	0.69	0.79	0.08
1/8	PD351	1/2-20	1.32	0.62	0.63	0.72	0.05
1/8	PD361	9/16-18	1.32	0.62	0.69	0.79	0.06

\* Note: Add -6 to part number to include dust cap, for example PD343-6

\* BPD designates brass body, Fluorocarbon seal standard

\*\* SSPD designates 316SS body, Fluorocarbon seal standard

Nipples

Bulkhead Triple-Lok

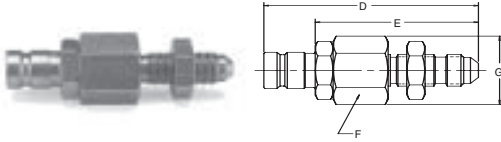

Body Size (in.)	Part No. Steel	Thread Size	Tube Size	Dimensions (in.)				Wt. (LB.) P/Piece	
				Overall Length	Exposed Length	Hex Size	Largest Diameter		
				D	E	F	G		
1/8	PD345	7/16-20	1/4	2.92	2.22	0.81	0.94	0.19	
1/8	PD355	1/2-20	5/16	2.92	2.22	0.81	0.94	0.19	
1/8	PD365	9/16-18	3/8	3.00	2.30	0.81	0.94	0.20	

Bulkhead Seal-Lok

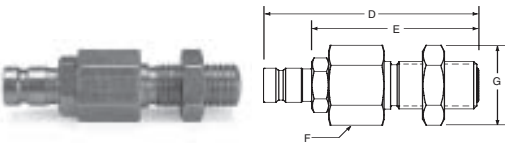

Body Size (in.)	Part No. Steel	Thread Size	Tube Size	Dimensions (in.)				Wt. (LB.) P/Piece	
				Overall Length	Exposed Length	Hex Size	Largest Diameter		
				D	E	F	G		
1/8	PD346	9/16-18	1/4	2.98	2.27	0.81	0.94	-	
1/8	PD366	11/16-16	3/8	3.08	2.37	1.00	1.16	-	
1/8	PD386	13/16-16	1/2	3.18	2.47	1.12	1.30	-	

Tube End Nipples\*

Triple-Lok  
PD — — BTX

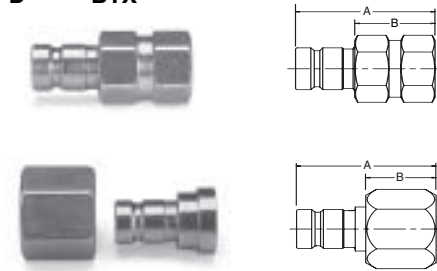

Body Size (in.)	Part No. Steel	Tube Size	Dimensions (in.)			Wt. (LB.) P/Piece
			Overall Length	Exposed Length		
			A	B		
1/8	PD34BTX	1/4	1.64	0.94	0.10	
1/8	PD36BTX	3/8	1.66	0.96	0.09	
			A	B		
1/8	PD38BTX	1/2	1.17	0.47	0.12	
1/8	PD312BTX	3/4	1.39	0.69	0.27	

\* Tube end nipples are designed to meet the performance standards of the tube or hose fitting connection, which may or may not meet SAE J1502 Standards.

Ferulok  
PD — — BTU



Body Size (in.)	Part No. Steel	Tube Size	Dimensions (in.)			Wt. (LB.) P/Piece
			Overall Length	Exposed Length		
			A	B		
1/8	PD38BTU	1/2	1.40	0.70	-	

\* Tube end nipples are designed to meet the performance standards of the tube or hose fitting connection, which may or may not meet SAE J1502 Standards.

Seal-Lok  
PD — — BTL

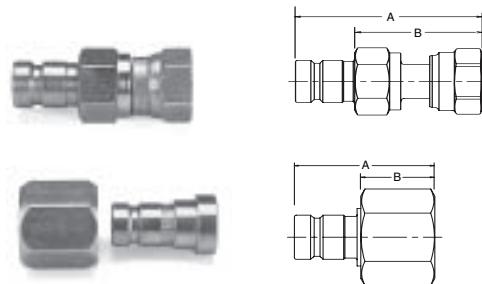

Body Size (in.)	Part No. Steel	Tube Size	Dimensions (in.)			Wt. (LB.) P/Piece
			Overall Length	Exposed Length		
			A	B		
1/8	PD34BTL	1/4	2.18	1.48	0.12	
1/8	PD36BTL	3/8	2.30	1.60	0.14	
			A	B		
1/8	PD38BTL	1/2	1.57	0.83	0.13	
1/8	PD310BTL	5/8	1.16	0.46	0.19	

\* Tube end nipples are designed to meet the performance standards of the tube or hose fitting connection, which may or may not meet SAE J1502 Standards.

Note: Add -6 to part number to include dust cap, for example PD343-6