

Общие данные

General data

Всоответствии с требованиями DIN 3015, крепежные хомуты производятся из:
Manufactured to DIN 3015, the collars clamps are manufactured in:

- Полипропилен с ребристыми половинками (по заказу гладкими) - для стандартной, тяжелой и сдвоенной серий
Polypropylene with ribbed clamp halve (on request smooth) - For standard, heavy-duty and double series.
- Полиамид - (нейлон 6-6, обогащен 20% стекловолокном, самозатухающий) - для стандартной, тяжелой и сдвоенной версий
Polyamide - (Nylon 6-6 loaded with 20% of fi breglass, self-extinguishing VO) - For standard, heavy-duty and double series.
- Резина - для стандартной, тяжелой и сдвоенной серий
Rubber - For standard, heavy-duty and double series.
- Аллюминия для крепежа труб легкой или тяжелой серии.
Aluminium - for standard and heavy-duty series.

Прочие металлические компоненты крепежа производятся из:
The other metallic components of the clamps are manufactured in:

- Сталь FE 35 - плиты основания, верхние плиты; сборочные рейки.
Steel FE 35 - lower and upper plates; mounting rails.
- Сталь A6S - болты и шайбы.
Сталь A6S - болты и шайбы.

Под заказ мы можем изготовить все металлические части из нержавеющей стали 304 - 316 и 316L.

On request we can produce all metallic parts in stainless steel 304 - 316 and 316L.

Как заказать

How to Order

CS **P** 1 - 0064

SCS **P** 1 - 0064

P	Полипропилен / Polypropylene	<i>(стандартный вариант)</i>
M	Полиамид / Polyamide	<i>(под заказ)</i>
R	Резина / Rubber	<i>(под заказ)</i>
A	Аллюминий / Aluminium	<i>(под заказ)</i>

Хомуты / Clamps

Страница / Page	2	3	4-6
standard clamps	 <p>CSPX Стандартный вариант - полипропиленовые полускобы</p>	 <p>CPPX Стандартные полускобы с верхней плитой из полипропилена</p>	 <p>- Стандартные компоненты крепежа</p>
Страница / Page	7		8-10
double clamps	 <p>CDPX Двойные полипропиленовые скобы</p>		 <p>- Компоненты двойного крепежа</p>
Страница / Page	11-12		13-16
heavy clamps	 <p>CHPX Полипропиленовый крепеж тяжелой серии</p>		 <p>- Компоненты крепежа тяжелой серии</p>

Dimensions and general characteristics may be changed at any time without prior notice.

Data contained herein are for information purpose only, and it does not enlarge, amend or imply any warranty other than provided by us with the product
Any use of the product not in conformance with our instructions may be dangerous.

CSPX Стандартный вариант - полипропиленовые полускобы

Standard clamps in Polypropilene

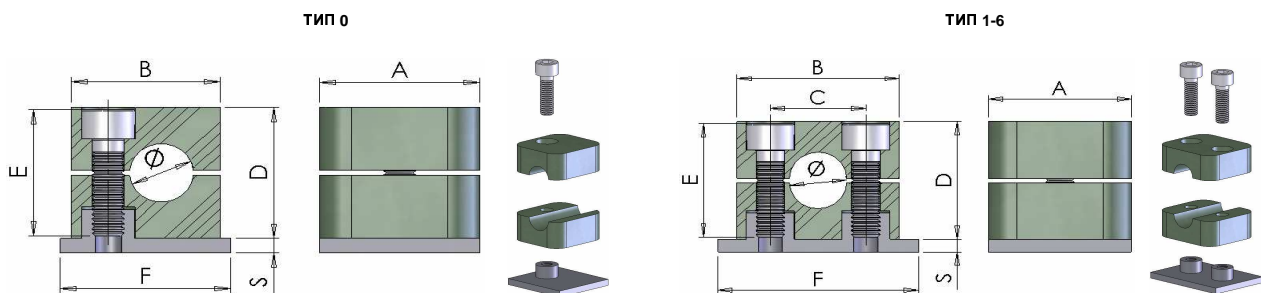

Codice Part number	Ø Tubo		Tipo Type	Dimensioni Dimension															
	Ø Tube			A	B	C	D	F	S	E									
	mm	Poll./Inch		mm															
CSP0-0060	6,0	1/8"	5/16"	0	30	28	-	27	32	3	M 6x20								
CSP0-0080	8,0																		
CSP0-0100	10,0																		
CSP0-0120	12,0																		
CSP1-0060	6,0	1/8"	1/4"	1	30	34	20	27	42	3	M 6x20								
CSP1-0064	6,4																		
CSP1-0080	8,0																		
CSP1-0095	9,5		5/8"																
CSP1-0100	10,0																		
CSP1-0120	12,0																		
CSP2-0127	12,7	1/4"	1/2"	2	30	40	26	33	48	3	M 6x25								
CSP2-0135	13,5																		
CSP2-0140	14,0																		
CSP2-0150	15,0																		
CSP2-0160	16,0	3/8"	3/4"	3	30	48	33	35	55	3	M 6x30								
CSP2-0172	17,2																		
CSP2-0180	18,0																		
CSP2-0190	19,0	1/2"	3/4"									4	30	57	40	42	62	3	M 6x35
CSP3-0190	19,0																		
CSP3-0200	20,0																		
CSP3-0213	21,3																		
CSP3-0220	22,0	1"	1 1/4"	5	30	68	52	58	74	3	M 6x50								
CSP3-0250	25,0																		
CSP3-0254	25,4																		
CSP4-0269	26,9	3/4"	1 1/4"									6	30	86	66	66	88	3	M 6x60
CSP4-0280	28,0																		
CSP4-0300	30,0																		
CSP4-0320	32,0																		
CSP5-0320	32,0	1"	1 1/2"	5	30	68	52	58	74	3	M 6x50								
CSP5-0337	33,7																		
CSP5-0350	35,0																		
CSP5-0380	38,0																		
CSP5-0400	40,0																		
CSP5-0420	42,0																		
CSP5-0424	42,4	1 1/4"	1 1/4"	6	30	86	66	66	88	3	M 6x60								
CSP5-0450	45,0																		
CSP6-0445	44,5																		
CSP6-0483	48,3	1 1/2"	2"	6	30	86	66	66	88	3	M 6x60								
CSP6-0508	50,8																		

CPPX Стандартные полускобы с верхней плитой из полипропилена

Standard clamps with upper plate in Polypropilene

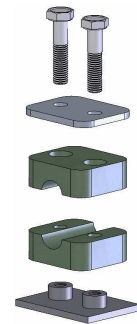
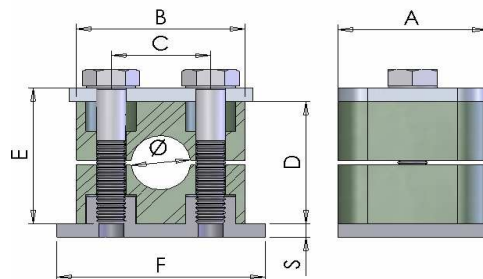

Codice Part number	Ø Tubo Ø Tube			Tipo Type	Dimensioni Dimension						
	Poll./Inch		X		A	B	C	D	F	S	E
	mm	Gas			O.D.	mm					
CPP1-0060	6,0			1	30	34	20	27	42	3	M 6x30
CPP1-0064	6,4		1/4"								
CPP1-0080	8,0		5/16"								
CPP1-0095	9,5		3/8"								
CPP1-0100	10,0	1/8"									
CPP1-0120	12,0										
CPP2-0127	12,7		1/2"	2	30	40	26	33	48	3	M 6x35
CPP2-0135	13,5	1/4"									
CPP2-0140	14,0										
CPP2-0150	15,0		5/8"								
CPP2-0160	16,0	3/8"									
CPP2-0172	17,2										
CPP2-0180	18,0		3/4"	3	30	48	33	35	55	3	M 6x40
CPP2-0190	19,0		3/4"								
CPP3-0190	19,0	1/2"									
CPP3-0200	20,0		7/8"								
CPP3-0213	21,3		1"								
CPP3-0220	22,0										
CPP3-0250	25,0			4	30	57	40	42	62	3	M 6x45
CPP3-0254	25,4	3/4"									
CPP4-0269	26,9										
CPP4-0280	28,0										
CPP4-0300	30,0			5	30	68	52	58	74	3	M 6x60
CPP4-0320	32,0	1.1/4"									
CPP5-0520	32,0	1"	1.1/4"								
CPP5-0337	33,7										
CPP5-0350	35,0		1.1/2"								
CPP5-0380	38,0										
CPP5-0400	40,0			6	30	86	66	66	88	3	M 6x70
CPP5-0420	42,0	1.1/4"									
CPP5-0424	42,4										
CPP5-0450	45,0										
CPP6-0445	44,5	1.1/2"	1.1/4"	6	30	86	66	66	88	3	M 6x70
CPP6-0483	48,3										
CPP6-0508	50,8	2"									

Стандартные компоненты крепежа

Standard clamps components

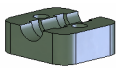
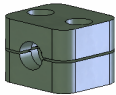
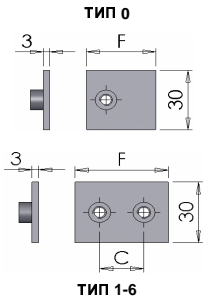
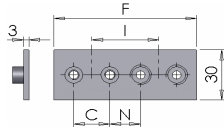
										
semi-collare in polipropilene		coppia collari in polipropilene		piastra inferiore		piastra inferiore doppia				
polypropilene clamp-half		polypropilene clamp body		lower plate		double lower plate				
code	price	code	price	(LPS...)		(LPDS...)				n°
				F	C	F	C	N	I	collari
				mm	mm	mm	mm	mm	mm	clamps
TIPO 0	SCSP0-0060	CCSP0-0060		LPS0		LPDS0				
	SCSP0-0080	CCSP0-0080		LPS0		LPDS0				
	SCSP0-0100	CCSP0-0100		32	-	61	-	-	30	2
	SCSP0-0120	CCSP0-0120		LPS0		LPDS0				
TIPO 1	SCSP1-0060	CCSP1-0060		LPS1		LPDS1				
	SCSP1-0064	CCSP1-0064		LPS1		LPDS1				
	SCSP1-0080	CCSP1-0080		LPS1		LPDS1				
	SCSP1-0095	CCSP1-0095		42	20	81	20	20	40	2
	SCSP1-0100	CCSP1-0100		LPS1		LPDS1				
	SCSP1-0120	CCSP1-0120		LPS1		LPDS1				
TIPO 2	SCSP2-0127	CCSP2-0127		LPS2		LPDS2				
	SCSP2-0135	CCSP2-0135		LPS2		LPDS2				
	SCSP2-0140	CCSP2-0140		LPS2		LPDS2				
	SCSP2-0150	CCSP2-0150		LPS2		LPDS2				
	SCSP2-0160	CCSP2-0160		48	26	91	26	18	44	2
	SCSP2-0172	CCSP2-0172		LPS2		LPDS2				
	SCSP2-0180	CCSP2-0180		LPS2		LPDS2				
	SCSP2-0190	CCSP2-0190		LPS2		LPDS2				
TIPO 3	SCSP3-0190	CCSP3-0190		LPS3		LPDS3				
	SCSP3-0200	CCSP3-0200		LPS3		LPDS3				
	SCSP3-0213	CCSP3-0213		LPS3		LPDS3				
	SCSP3-0220	CCSP3-0220		55	33	106	33	19	52	2
	SCSP3-0250	CCSP3-0250		LPS3		LPDS3				
	SCSP3-0254	CCSP3-0254		LPS3		LPDS3				
TIPO 4	SCSP4-0269	CCSP4-0269		LPS4		LPDS4				
	SCSP4-0280	CCSP4-0280		LPS4		LPDS4				
	SCSP4-0300	CCSP4-0300		62	40	148	52	23	75	2
	SCSP4-0320	CCSP4-0320		LPS4		LPDS4				
TIPO 5	SCSP5-0320	CCSP5-0320		LPS5		LPDS5				
	SCSP5-0337	CCSP5-0337		LPS5		LPDS5				
	SCSP5-0350	CCSP5-0350		LPS5		LPDS5				
	SCSP5-0380	CCSP5-0380		LPS5		LPDS5				
	SCSP5-0400	CCSP5-0400		74	52	148	52	23	75	2
	SCSP5-0420	CCSP5-0420		LPS5		LPDS5				
	SCSP5-0424	CCSP5-0424		LPS5		LPDS5				
	SCSP5-0450	CCSP5-0450		LPS5		LPDS5				
TIPO 6	SCSP6-0445	CCSP6-0445		LPS6		LPDS6				
	SCSP6-0483	CCSP6-0483		LPS6		LPDS6				
	SCSP6-0508	CCSP6-0508		88	66	177	66	24	90	2

Стандартные компоненты крепежа

Standard clamps components

		ТИП 0					ТИП 1-6							
		piastra inferiore multipla					piastra superiore		vite T.C.E.I.		vite a testa esagonale		vite a testa esag. allungata	
		multiple lower plate					upper plate		T.C.E.I. screws		hexagonal head screw		high hexagonal head screw	
		(LPMS...)				n°	(UPS...)		(VTEIS...)		(VTES...)		(VTEAS...)	
		F	C	N	I	collari	F	C	M	E	M	E	M	E
		mm	mm	mm	mm	clamps	mm	mm	mm	mm	mm	mm	mm	mm
ТИП 0		LPMS0					UPS0		VTEIS0		VTES0		VTEAS0	
		306	-	-	30	10	28	-	M6	20	M6	30	M6	20
ТИП 1		LPMS1					UPS1		VTEIS1		VTES1		VTEAS1	
		404	20	20	40	10	37	20	M6	20	M6	30	M6	20
ТИП 2		LPMS2					UPS2		VTEIS2		VTES2		VTEAS2	
		447	26	18	44	10	43	26	M6	25	M6	35	M6	25
ТИП 3		LPMS3					UPS3		VTEIS3		VTES3		VTEAS3	
		525	33	19	52	10	50	33	M6	30	M6	40	M6	30
ТИП 4		LPMS4					UPS4		VTEIS4		VTES4		VTEAS4	
		375	52	53	75	5	57	40	M6	35	M6	45	M6	35
ТИП 5		LPMS5					UPS5		VTEIS5		VTES5		VTEAS5	
		375	52	23	75	5	69	52	M6	50	M6	60	M6	50
ТИП 6		LPMS6					UPS6		VTEIS6		VTES6		VTEAS6	
		447	66	24	90	5	83	66	M6	60	M6	70	M6	60

Стандартные компоненты крепежа

Standard clamps components

piastra sup. di sicurezza		binari portanti (spessore 2 mm.)		dado fissaggio binari		rondella
security upper plate		rail (thickness 2 mm)		Rail Nut		flat washer
(SUPS...)		(BINS...)		(FIXS...)		(RONS...)
F	C	b	h	M	d	
mm	mm	mm	mm		mm	
SUPS0						
ТИП 0	28	-				
SUPS1						
ТИП 1	34	20				
SUPS2		BINS1				
ТИП 2	41	26	28	11		
SUPS3		BINS2		FIXS1		RONS1
ТИП 3	47	33	28	14	M6	M6
SUPS4		BINS3				
ТИП 4	57	40				
SUPS5						
ТИП 5	67	52	28	30		
SUPS6						
ТИП 6	82	66				

CDPX Двойные полипропиленовые скобы

Double Polypropylene Clamps

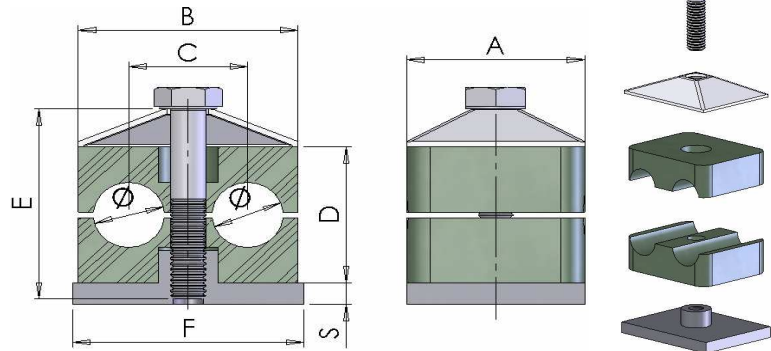

Codice Part number	Ø Tubo Ø Tube			Tipo Type	Dimensioni Dimension						
	Poll./Inch		X		A	B	C	D	F	S	E
	mm	Gas			O.D.	mm					
CDP1-0060	6,0										
CDP1-0064	6,4		1/4"								
CDP1-0080	8,0		5/16"	1	30	37	20	25	37	3	M 6x35
CDP1-0095	9,5		3/8"								
CDP1-0100	10,0	1/8"									
CDP1-0120	12,0										
CDP2-0127	12,7		1/2"								
CDP2-0135	13,5	1/4"		2	30	53	29	26	55	5	M 6x35
CDP2-0140	14,0										
CDP2-0150	15,0		5/8"								
CDP2-0160	16,0										
CDP2-0172	17,2	3/8"									
CDP2-0180	18,0										
CDP3-0190	19,0		3/4"								
CDP3-0200	20,0			3	30	67	36	37	70	5	M 6x45
CDP3-0213	21,3	1/2"									
CDP3-0220	22,0		7/8"								
CDP3-0250	25,0										
CDP3-0254	25,4		1"								
CDP4-0269	26,9	3/4"		4	30	82	45	42	85	5	M 6x50
CDP4-0280	28,0										
CDP4-0300	30,0										
CDP5-0320	32,0		1.1/4"	5	30	106	56	54	110	5	M 6x60
CDP5-0337	33,7	1"									
CDP5-0350	35,0										
CDP5-0380	38,0		1.1/2"								
CDP5-0400	40,0										
CDP5-0420	42,0										
CDP5-0424	42,4	1.1/4"									

Компоненты двойного крепежа

Double clamps components

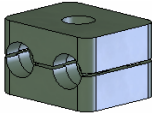
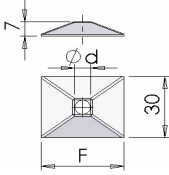
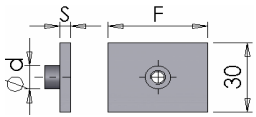
								
semi-collare in polipropilene polypropilene clamp-half		coppia collari in polipropilene polypropilene clamp body		piastra superiore upper plate		piastra inferiore lower plate		
code	price	code	price	(UPD...)		(LPD...)		
				F mm	Ød mm	F mm	Ød mm	S mm
ТИП 1	SCDP1-0060	CCDP1-0060		UPD1		LPD1		
	SCDP1-0064	CCDP1-0064						
	SCDP1-0080	CCDP1-0080						
	SCDP1-0095	CCDP1-0095		35	7	37	12	3
	SCDP1-0100	CCDP1-0100						
	SCDP1-0120	CCDP1-0120						
ТИП 2	SCDP2-0127	CCDP2-0127		UPD2		LPD2		
	SCDP2-0135	CCDP2-0135						
	SCDP2-0140	CCDP2-0140						
	SCDP2-0150	CCDP2-0150		52	9	55	14	5
	SCDP2-0160	CCDP2-0160						
	SCDP2-0172	CCDP2-0172						
ТИП 3	SCDP3-0190	CCDP3-0190		UPD3		LPD3		
	SCDP3-0200	CCDP3-0200						
	SCDP3-0213	CCDP3-0213						
	SCDP3-0220	CCDP3-0220		66	9	70	14	5
	SCDP3-0250	CCDP3-0250						
	SCDP3-0254	CCDP3-0254						
ТИП 4	SCDP4-0269	CCDP4-0269		UPD4		LPD4		
	SCDP4-0280	CCDP4-0280						
	SCDP4-0300	CCDP4-0300		81	9	85	14	5
ТИП 5	SCDP5-0320	CCDP5-0320		UPD5		LPD5		
	SCDP5-0337	CCDP5-0337						
	SCDP5-0350	CCDP5-0350						
	SCDP5-0380	CCDP5-0380		105	9	110	14	5
	SCDP5-0400	CCDP5-0400						
	SCDP5-0420	CCDP5-0420						
SCDP5-0424	CCDP5-0424							

Компоненты двойного крепежа

Double clamps components

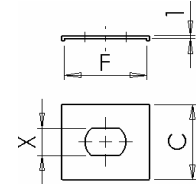
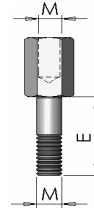
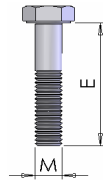
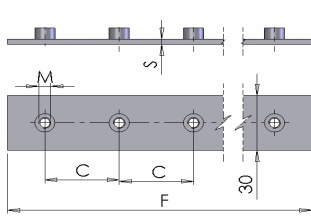

	piastra inferiore multipla multiple lower plate					vite a testa esagonale hexagonal head screw		vite a testa esag. allungata high hexagonal head screw		piastra sup. di sicurezza security upper plate		
	(LPMD...)				n° collari clamps	(VTED...)		(VTEAD...)		(SUPD...)		
	F mm	C mm	S mm	M		M	E mm	M	E mm	F mm	C mm	X mm
ТИП 1	LPMD1					VTED1		VTEAD1		SUPD1		
	200	40	3	M6	5	M6	35	M6	20	30	30	11
ТИП 2	LPMD2					VTED2		VTEAD2		SUPD2		
	290	58	5	M8	5	M8	35	M8	20			
ТИП 3	LPMD3					VTED3		VTEAD3				
	360	72	5	M8	5	M8	45	M8	29			
ТИП 4	LPMD4					VTED4		VTEAD4				
	450	90	5	M8	5	M8	50	M8	34			
ТИП 5	LPMD5					VTED5		VTEAD5				
	560	112	5	M8	5	M8	60	M8	47			

Компоненты двойного крепежа

Double clamps components

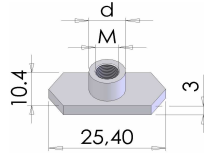
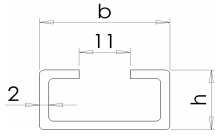

binari portanti (spessore 2 mm.)		dado fissaggio binari	
rail (thickness 2 mm)		Rail Nut	
(BIND...)		(FIXD...)	
b	h	M	d
mm	mm		mm
BIND1		FIXD1	
		M6	12
28	11	FIXD2	
BIND2			
28	14	M8	14
BIND3			
28	30		

ТИП 1

ТИП 2

ТИП 3

ТИП 4

ТИП 5

CHPX Полипропиленовый крепеж тяжелой серии

Heavy duty Polypropilene Clamps

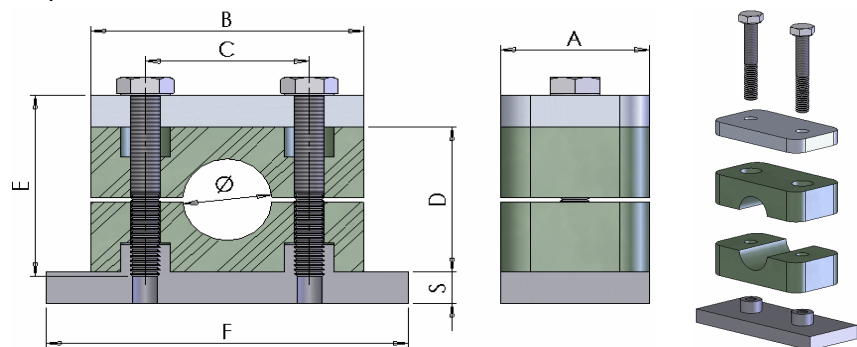

Codice Part number	Ø Tubo Ø Tube			Tipo Type	Dimensioni Dimension						
	Poll./Inch		X		A	B	C	D	F	S	E
	mm	Gas		O.D.		mm					
CHP1-0060	6,0										
CHP1-0064	6,4		1/4"								
CHP1-0080	8,0		5/16"								
CHP1-0095	9,5		3/8"								
CHP1-0100	10,0	1/8"									
CHP1-0120	12,0										
CHP1-0127	12,7		1/2"	1	30	55	33	32	73	8	M 6x35
CHP1-0135	13,5	1/4"									
CHP1-0140	14,0										
CHP1-0150	15,0										
CHP1-0160	16,0		5/8"								
CHP1-0172	17,2	3/8"									
CHP1-0180	18,0										
CHP2-0190	19,0		3/4"								
CHP2-0200	20,0										
CHP2-0213	21,3	1/2"									
CHP2-0220	22,0		7/8"								
CHP2-0250	25,0			2	30	70	45	48	85	8	M 6x35
CHP2-0254	25,4		1"								
CHP2-0269	26,9	3/4"									
CHP2-0280	28,0										
CHP2-0300	30,0										
CHP3-0300	30,0										
CHP3-0320	32,0		1.1/4"								
CHP3-0337	33,7	1"									
CHP3-0350	35,0										
CHP3-0380	38,0		1.1/2"	3	30	85	60	60	10	8	M 6x45
CHP3-0400	40,0										
CHP3-0420	42,0										
CHP3-0424	42,4	1.1/4"									
CHP4-0380	38,0		1.1/2"								
CHP4-0420	42,0										
CHP4-0424	42,4	1.1/4"		4	45	120	90	90	140	10	M 12x100
CHP4-0445	44,5		1.3/4"								
CHP4-0483	48,3	1.1/2"									

CHPX Полипропиленовый крепеж тяжелой серии

Heavy duty Polypropilene Clamps

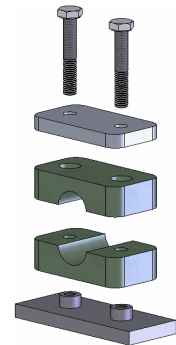
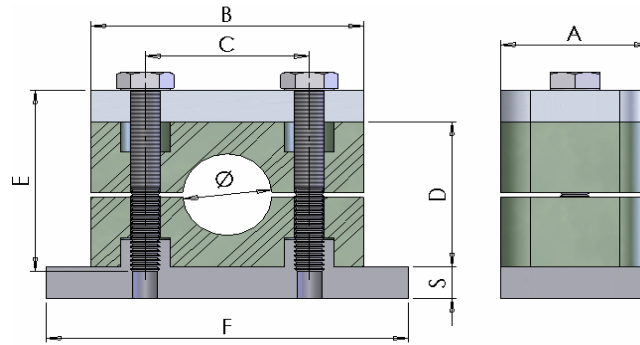

Codice Part number	Ø Tubo Ø Tube			Tipo Type	Dimensioni Dimension														
	Poll./Inch		X		A	B	C	D	F	S	E								
	mm	Gas			O.D.	mm													
CHP4-0500	50,0																		
CHP4-0508	50,8		2"																
CHP4-0550	55,0																		
CHP4-0570	57,0		2.1/4"	4	45	120	90	90	140	10	M 12x100								
CHP4-0603	60,3	2"																	
CHP4-0635	63,5		2.1/2"																
CHP4-0650	65,0																		
CHP4-0700	70,0		2.3/4"																
CHP5-0650	65,0																		
CHP5-0700	70,0																		
CHP5-0750	75,0																		
CHP5-0761	76,1	2.1/2"	3"	5	60	152	122	120	180	10	M 16x130								
CHP5-0800	80,0																		
CHP5-0825	82,5		3.1/4"																
CHP5-0889	88,9	3"	3.1/2"																
CHP6-0899	89,9	3"	3.1/2"																
CHP6-1000	100,0																		
CHP6-1016	101,6	3.1/2"	4"									6	80	205	168	170	225	15	M 20x190
CHP6-1080	108,0		4.1/4"																
CHP6-1143	114,3	4"	4.1/2"																
CHP6-1270	127,0	4.1/2"	5"																
CHP6-1330	133,0		5.1/2"																
CHP7-1330	133,0		5.1/4"																
CHP7-1397	139,7	5"	5.1/2"	7	90	250	205	200	270	15	M 24x220								
CHP7-1524	152,4	5.1/2"	6"																
CHP7-1650	165,0		6.1/2"																
CHP7-1683	168,3	6"																	
CHP8-1683	168,3	6"																	
CHP8-1778	177,8		7"									8	120	320	265	270	340	25	M 30x300
CHP8-1937	193,7		7.5/8"																
CHP8-2160	216,0		8.1/2"																
CHP8-2191	219,1	8"																	

Компоненты крепежа тяжелой серии

Heavy clamps components

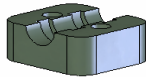
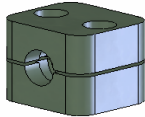
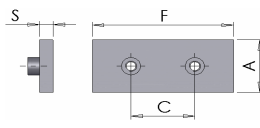
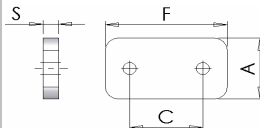
 semi-collare in polipropilene polypropilene clamp-half		 coppia collari in polipropilene polypropilene clamp body		 piastra inferiore lower plate				 piastra superiore upper plate					
code	price	code	price	(LPH...)				(UPH...)					
				A mm	F mm	C mm	S mm	A mm	F mm	C mm	S mm		
				LPH1				UPH1					
ТИП 1													
SCHP1-0060		CCHP1-0060											
SCHP1-0064		CCHP1-0064											
SCHP1-0080		CCHP1-0080											
SCHP1-0095		CCHP1-0095											
SCHP1-0100		CCHP1-0100											
SCHP1-0120		CCHP1-0120											
SCHP1-0127		CCHP1-0127		30	75	33	8	30	55	33	8		
SCHP1-0135		CCHP1-0135											
SCHP1-0140		CCHP1-0140											
SCHP1-0150		CCHP1-0150											
SCHP1-0160		CCHP1-0160											
SCHP1-0172		CCHP1-0172											
SCHP1-0180		CCHP1-0180											
				LPH2				UPH2					
ТИП 2													
SCHP2-0190		CCHP2-0190											
SCHP2-0200		CCHP2-0200											
SCHP2-0213		CCHP2-0213											
SCHP2-0220		CCHP2-0220											
SCHP2-0250		CCHP2-0250											
SCHP2-0254		CCHP2-0254		30	87	45	8	30	70	45	8		
SCHP2-0269		CCHP2-0269											
SCHP2-0280		CCHP2-0280											
SCHP2-0300		CCHP2-0300											
SCHP2-0300		CCHP2-0300											
				LPH3				UPH3					
ТИП 3													
SCHP3-0300		CCHP3-0300											
SCHP3-0320		CCHP3-0320											
SCHP3-0337		CCHP3-0337											
SCHP3-0350		CCHP3-0350											
SCHP3-0380		CCHP3-0380		30	102	60	8	30	85	60	8		
SCHP3-0400		CCHP3-0400											
SCHP3-0420		CCHP3-0420											
SCHP3-0424		CCHP3-0424											
				LPH4				UPH4					
ТИП 4													
SCHP4-0380		CCHP4-0380											
SCHP4-0420		CCHP4-0420											
SCHP4-0424		CCHP4-0424											
SCHP4-0445		CCHP4-0445		45	140	90	10	45	120	90	10		
SCHP4-0483		CCHP4-0483											

Компоненты крепежа тяжелой серии

Heavy clamps components

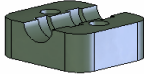
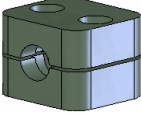
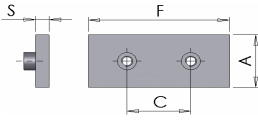
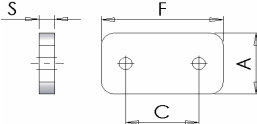
													
semi-collare in polipropilene		coppia collari in polipropilene		piastra inferiore				piastra superiore					
polypropilene clamp-half		polypropilene clamp body		lower plate				upper plate					
code	price	code	price	(LPH...)				(UPH...)					
				A mm	F mm	C mm	S mm	A mm	F mm	C mm	S mm		
				LPH4				UPH4					
SCHP4-0500		CCHP4-0500											
SCHP4-0508		CCHP4-0508											
SCHP4-0550		CCHP4-0550											
SCHP4-0570		CCHP4-0570											
SCHP4-0603		CCHP4-0603		45	140	90	10	45	120	90	10		
SCHP4-0635		CCHP4-0635											
SCHP4-0650		CCHP4-0650											
SCHP4-0700		CCHP4-0700											
				LPH5				UPH5					
SCHP5-0650		CCHP5-0650											
SCHP5-0700		CCHP5-0700											
SCHP5-0750		CCHP5-0750											
SCHP5-0761		CCHP5-0761		60	180	122	10	60	152	122	10		
SCHP5-0800		CCHP5-0800											
SCHP5-0825		CCHP5-0825											
SCHP5-0889		CCHP5-0889											
				LPH6				UPH6					
SCHP6-0899		CCHP6-0899											
SCHP6-1000		CCHP6-1000											
SCHP6-1016		CCHP6-1016											
SCHP6-1080		CCHP6-1080		80	225	168	15	80	205	168	15		
SCHP6-1143		CCHP6-1143											
SCHP6-1270		CCHP6-1270											
SCHP6-1330		CCHP6-1330											
				LPH7				UPH7					
SCHP7-1330		CCHP7-1330											
SCHP7-1397		CCHP7-1397											
SCHP7-1524		CCHP7-1524											
SCHP7-1650		CCHP7-1650		90	270	205	15	90	250	205	15		
SCHP7-1683		CCHP7-1683											
				LPH8				UPH8					
SCHP8-1683		CCHP8-1683											
SCHP8-1778		CCHP8-1778											
SCHP8-1937		CCHP8-1937											
SCHP8-2160		CCHP8-2160		120	340	265	25	120	320	265	25		
SCHP8-2191		CCHP8-2191											

Компоненты крепежа тяжелой серии

Heavy clamps components

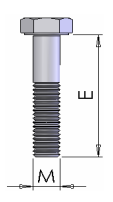
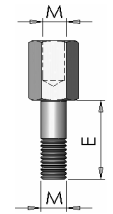
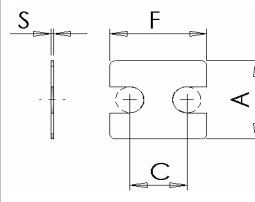
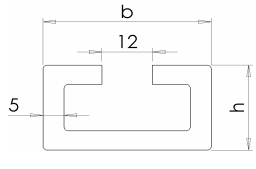
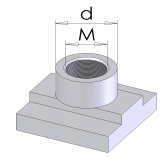
					
	vite a testa esagonale	vite a testa esag. allungata	piastra superiore di sicurezza	binari portanti (spessore 5 mm.)	dado fissaggio binari
	hexagonal head screw	high hexagonal head screw	security upper plate	rail (thickness 5 mm)	rail nut
	(VTEH...)	(VTEAH...)	(SUPH...)	(BINH...)	(FIXH...)
	M E mm	M E mm	A F C S mm mm mm mm	b h mm mm	M d mm
ТИП 1	VTEH1	VTEAH1	SUPH1		
	M10 45	M10 26	30 55 33 8		
	VTEH2	VTEAH2	SUPH2	BINH1	FIXH1
ТИП 2	M10 60	M10 41	30 70 45 8	40 22	M10 18
ТИП 3	VTEH3	VTEAH3	SUPH3		
	M10 70	M10 52	30 85 60 8		

Компоненты крепежа тяжелой серии

Heavy clamps components

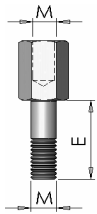
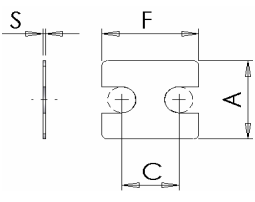
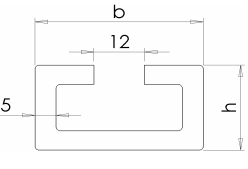
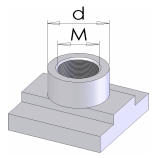
					
	vite a testa esagonale	vite a testa esag. allungata	piastra superiore di sicurezza	binari portanti (spessore 5 mm.)	dado fissaggio binari
	hexagonal head screw	high hexagonal head screw	security upper plate	rail (thickness 5 mm)	rail nut
	(VTEH...)	(VTEAH...)	(SUPH...)	(BINH...)	(FIXH...)
	M E mm	M E mm	A F C S mm mm mm mm	b h mm mm	M d mm
ТИП 4	VTEH4	VTEAH4	SUPH4	BINH1	FIXH2
	M12 100	M12 83	45 120 90 10		
ТИП 5	VTEH5	VTEAH5	SUPH5		
	M16 130	M16 110	60 152 122 10		
ТИП 6	VTEH6	-	-		
	M20 190	-	-		
ТИП 7	VTEH7	-	-		
	M24 220	-	-		
ТИП 8	VTEH8	-	-		
	M30 300	-	-		